

Top Roller Conveyor Chains

톱롤러 컨베이어 체인

TR-1 Type

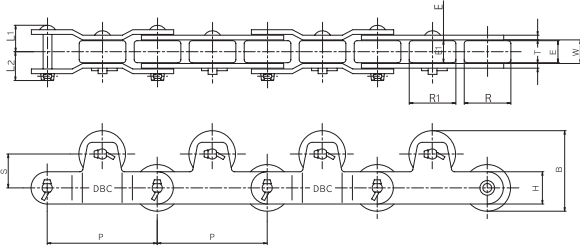

TR-2 Type

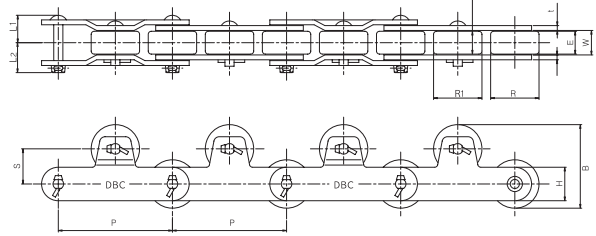

* 주문시에는 톱롤러의 부착 간격을 명시하여 주십시오.
* When ordering, please indicate spacing for installiy breakes of top rollers

unit : mm

Dong Bo CHAIN NO.	Pitch P	Approx weight	Roller		Inner Width W	Plate		Pin		S	Top Roller		B	Type	add. weight Per top roller (kg/each)	max Allowable Load Per top roller (kg/each)	
			R	E		H	T	L1	L2		R1	E1				Standard series	Heavy series
DBC 03075R-TR	75	2.7										PL20					
DBC 03100R-TR	100	2.3	31.8	15.5	16.1	22	3.2	18	20	23.1	40	RL13	59	☆	0.18	35	60
DBC 05100R-TR	100	5.0															
DBC 05100R-TR	150	4.1	40	19	22	32	4.5	25	28.5	30	40	19	70	TR1	0.26	65	105
DBC 03100R-TR	150	5.5	44.5	23	27	28.6	6.3	31	34.5	30	40	23	72.2	TR1	0.35	80	130
DBC 10150R-TR	150	7.9	50.8	27	30	38.1	6.3	33	36	30	50.8	27	80.8	TR1	0.56	115	195
DBC 6250R-TR	152.4	12.1	57.2	32	37.1	44.5	7.9	40.5	43	37.8	57.2	32	95	TR1	0.91	150	255
DBC 12200R-TR	200	11.4	65	32	37.1	44.5	7.9	40.5	43	45	65	32	110	TR1	1.15	150	255
DBC 17200R-TR	200	18.8	80	44	51.4	50.8	9.5	51.5	58	65	80	44	145	TR2	2.58	250	420

주) ☆표시 치수는 링크플레이트가 절곡되지 않은 평행형이므로 핀링크플레이트:20, 로울러 링크플레이트:13입니다.
Note) ☆=Pin Link plate:20, Roller Link plate :13

사용예 Application of Attachment

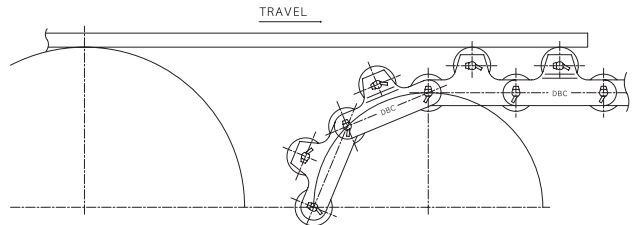
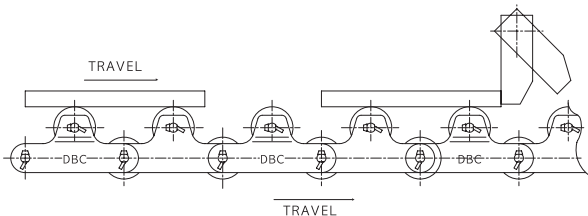

1. 체인을 연속가동하여, 운반물을 스톱퍼 (Stopper)에 의해 저장 (Stock)
2. 동일 체인상에서 수송, 정지작업을 동시에 시행
1. Temporarily stop and accumulate of items without halting the entire line.
2. Transporting, stopping and accumulating in same conveyor line.

- 이재시 충격완화
- Top roller can absorb shock on impact for movement