

A3- TYPE

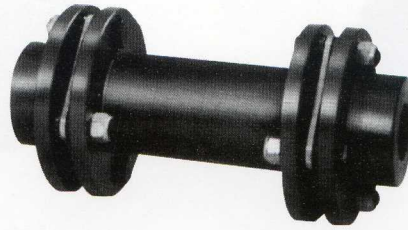

Ax, A4 - TYPE



A5 - TYPE

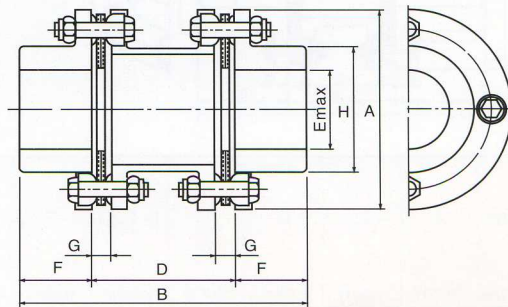
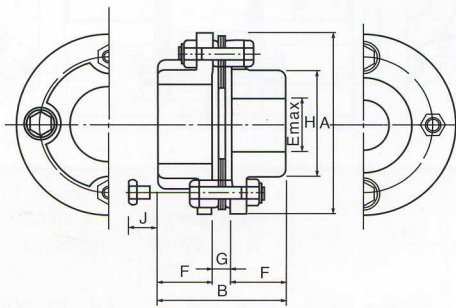

(A3 - TYPE) 4-Bolt

Size No.	Basic torque (Kg.m)	Max radial load (kg)	Max. rpm	표준허브(N-Hub)						특정허브(K-Hub)			Weight (kg)	GD ²
				A	B	Emax	F	G	H	P-Hub		Z-Hub		
										F	H	Emax		
05	3.4	15	47,000	67.4	56.9	22	25.4	6.1	33.1	40	47	32	8	0.6
10	9.2	25	39,000	81.1	57.4	32	25.4	6.6	45.8	40	58	40	24	1.1
15	18	56	34,000	92.8	65.8	35	28.7	8.4	50.8	45	66	42	48	1.7
20	25	83	30,000	103.7	78.2	42	33.5	11.2	61.0	50	77	48	80	2.4
25	43	120	25,000	125.8	93.9	50	41.1	11.7	71.2	60	92	60	224	4.3
30	79	180	22,000	143.0	107.3	60	47.8	11.7	83.9	70	104	70	440	6.9
35	130	270	19,000	168.0	131.2	72	57.2	16.8	105.5	85	129	85	1080	11.5
40	210	380	16,000	194.1	144.1	82	63.5	17.0	118.2	100	147	95	2080	16.4
45	340	450	15,000	214.2	174.0	95	76.2	21.6	137.2	115	166	110	3520	28.0
50	500	610	13,000	246.2	201.7	108	88.9	23.9	156.3	135	191	120	7200	37.0
55	650	770	11,000	275.6	230.4	118	101.6	27.2	169.0	150	209	130	12800	51.0

(Ax, A4 - TYPE) 4-Bolt

Size No.	Basic torque (kg · m)	Max. Speed rpm	A4(Standard)			Ax(Short)			AB(Custom)		
			D	Weight (kg)	GD ² (kg · cm ²)	D	Weight	GD ²	Ba	D	D Max
05	3.4	47,000	88.9	1.2	18	36	1.1	17.8	2F + D	고객주문 사양	300
10	9.2	39,000	88.9	1.9	44	39	1.7	41			200
15	18	34,000	101.6	2.9	84	47	2.7	79			250
20	25	30,000	127.0	7.1	396	53	6.6	136			250
25	43	25,000	127.0	7.1	386	62	6.6	337			350
30	79	22,000	127.0	10.8	386	69	6.6	775			350
35	130	19,000	127.0	16.3	1680	78	15.6	1628			300
40	210	6,000	139.7	24.7	3400	89	24.0	3317			350
45	340	15,000	152.4	32.5	5600	97	31.5	5428			350
50	500	13,000	177.8	50.0	11200	109	48.4	10865			350
55	650	11,000	177.8	75.0	20400	134	73.9	20127			400



E4-TYPE

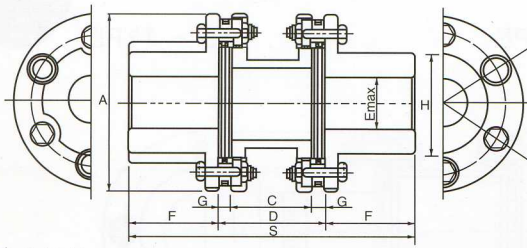

(E4 TYPE) 6-Bolt



G4-TYPE

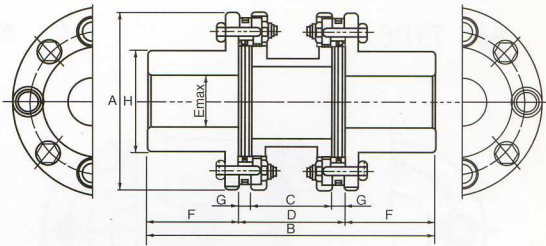

Size No.	Torque (kg · m)	A (mm)	B (mm)	C (mm)	(1) D (mm)	E Max (mm)	F (mm)	G (mm)	H (mm)	Max (rpm)	Weight W (Kg)	Inertial Effect GD ² (Kg · m ²)	Torsional stiffness (Kg · m/rad)	(2)	(3)
														Allow- able End Float (±mm)	Axial Spring Constat (kg/mm)
00	58	119	168	39.4	60	51	54	10.3	74	26,000	6.0	0.03	0.45 × 10 ⁵	3.0	16.5
01	94	137	198	50.0	72	55	63	11.0	81	23,000	9.1	0.06	0.69 × 10 ⁵	3.4	21.1
02	174	161	238	67.2	90	67	74	11.4	97	19,000	16.9	0.14	0.94 × 10 ⁵	3.6	28.0
03	341	180	269	82.4	109	72	80	13.3	104	17,000	21.6	0.26	1.61 × 10 ⁵	4.2	45.7
04	633	212	308	87.6	118	85	95	15.2	124	15,000	35.1	0.59	3.14 × 10 ⁵	4.5	60.6
05	620	276	377	118	153	111	112	17.5	161	11,600	65.1	1.8	3.98 × 10 ⁵	3.9	42.2
10	840	276	377	115	153	111	112	19.0	161	11,600	66.1	1.9	4.95 × 10 ⁵	3.9	59.5
15	1,090	308	440	134	172	133	134	19.0	193	10,300	107.8	3.7	7.34 × 10 ⁵	4.2	57.0
20	1,820	346	497	148	191	152	153	21.5	218	9,200	156.1	6.7	1.22 × 10 ⁶	4.9	76.2
25	2,690	375	553	175	223	165	165	24.0	240	8,500	211.8	10.6	1.70 × 10 ⁶	5.2	85.7
30	3,410	410	610	195	254	178	178	29.5	258	7,800	274.5	16.5	2.17 × 10 ⁶	5.4	99.2
35	4,070	445	646	211	270	187	188	29.5	272	7,200	333.3	23.9	2.44 × 10 ⁶	5.6	103.4
40	4,720	470	686	212	274	205	206	31.0	297	6,800	399.2	30.7	2.99 × 10 ⁶	6.3	102.0
45	6,100	511	749	223	287	231	231	32.0	334	6,200	525.3	48.0	3.86 × 10 ⁶	6.7	100.5
50	7,620	556	800	227	292	254	254	32.5	364	5,700	676.3	72.9	4.80 × 10 ⁶	7.3	113.3
55	9,440	587	839	243	311	263	264	34.0	382	5,400	803.4	100.6	6.09 × 10 ⁶	7.8	123.2
60	10,890	629	895	274	343	275	276	34.5	399	5,000	954.1	137.4	6.60 × 10 ⁶	8.7	131.0
65	13,070	654	934	285	356	289	289	35.5	419	4,800	1,095.3	176.9	7.98 × 10 ⁶	8.9	138.3

(G4 TYPE) 8-Bolt

Size No.	Torque (kg · m)	A (mm)	B (mm)	C (mm)	D (mm)	Emax (mm)	F (mm)	G (mm)	H (mm)	Max (rpm)	Weight (kg)	GD ² (kg · m ²)	Allowable Endfloat (±mm)	Torsional Stiffness (kg · m)
01	392	214	333	92.6	117	95	108	12.2	137	15,000	38.0	0.65	2.1	7.3
03	726	246	369	99.6	127	108	121	13.7	156	13,000	55.5	1.24	2.1	15.9
05	915	276	421	118	153	111	134	17.5	161	11,600	72.2	1.8	2.1	22.1
10	1,100	276	421	115	153	111	134	19.0	161	11,600	73.3	1.8	2.1	22.1
15	1,570	308	492	134	172	133	160	19.0	193	10,300	119.7	3.7	2.4	45
20	2,610	346	557	146	191	152	183	22.5	218	9,200	174.3	6.8	2.9	58
25	3,850	375	619	167	223	165	198	28.0	240	8,500	233.8	10.8	3.1	110
30	4,810	410	682	192	254	178	214	31.0	258	7,800	305.3	16.7	3.3	150
35	5,820	445	720	208	270	187	225	31.0	272	7,200	367.4	25.0	3.6	170
40	6,570	470	768	206	274	205	247	34.0	297	6,800	447.5	31.1	4.0	170
45	8,530	511	843	221	287	231	278	35.0	334	6,200	591.6	48.0	4.5	170
50	10,530	556	902	218	292	254	305	37.0	364	5,700	761.4	74.7	5.0	310
55	13,070	587	945	236	311	263	317	37.5	382	5,400	901.9	101.6	5.2	360